

INDUSTRIAL FIRE WORLD  
 MARCH 23 - 27, 2009

HOLIDAY INN  
 HOTEL & SUITES  
 HOUSTON & SAN ANTONIO BALLROOMS  
 3950 I-10 SOUTH  
 BEAUMONT, TX 77705

SCALE  
 0 10 20 30  
 34 - 8 X 10 BOOTHS  
 (\*55 SET-UP LAST)

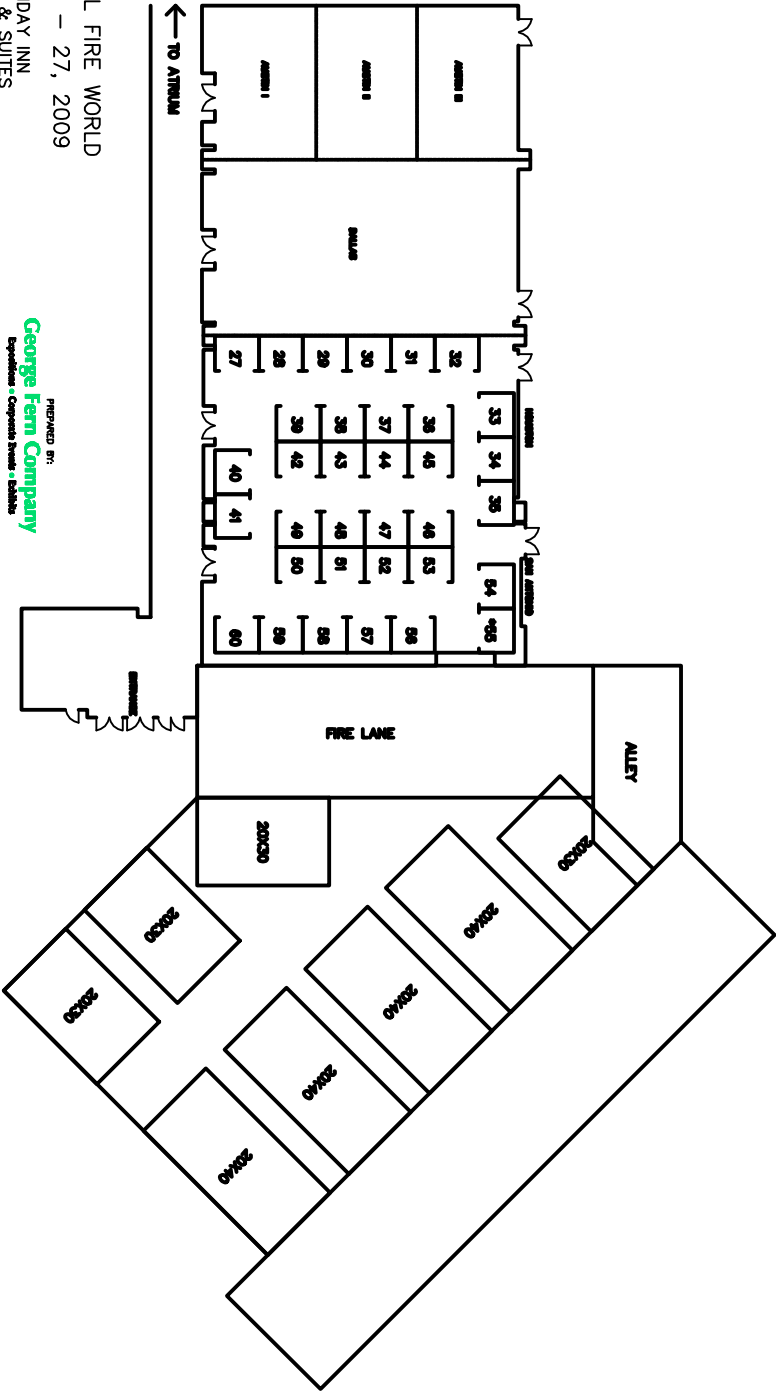

PREPARED BY:  
**George Fern Company**  
 Exhibitors • Corporate Events • Exhibits  
 Midlandville

7700 N. FRIEDWAY SUITE B, HOUSTON, TX 77037  
 (281) 280-7200 FAX (281) 280-7271  
 FILE # PREPARED 2008-04-04/27/08 cc/lf

All information on this floor plan is provided for informational purposes only. The actual layout of the building may vary from the floor plan. The floor plan is subject to change.

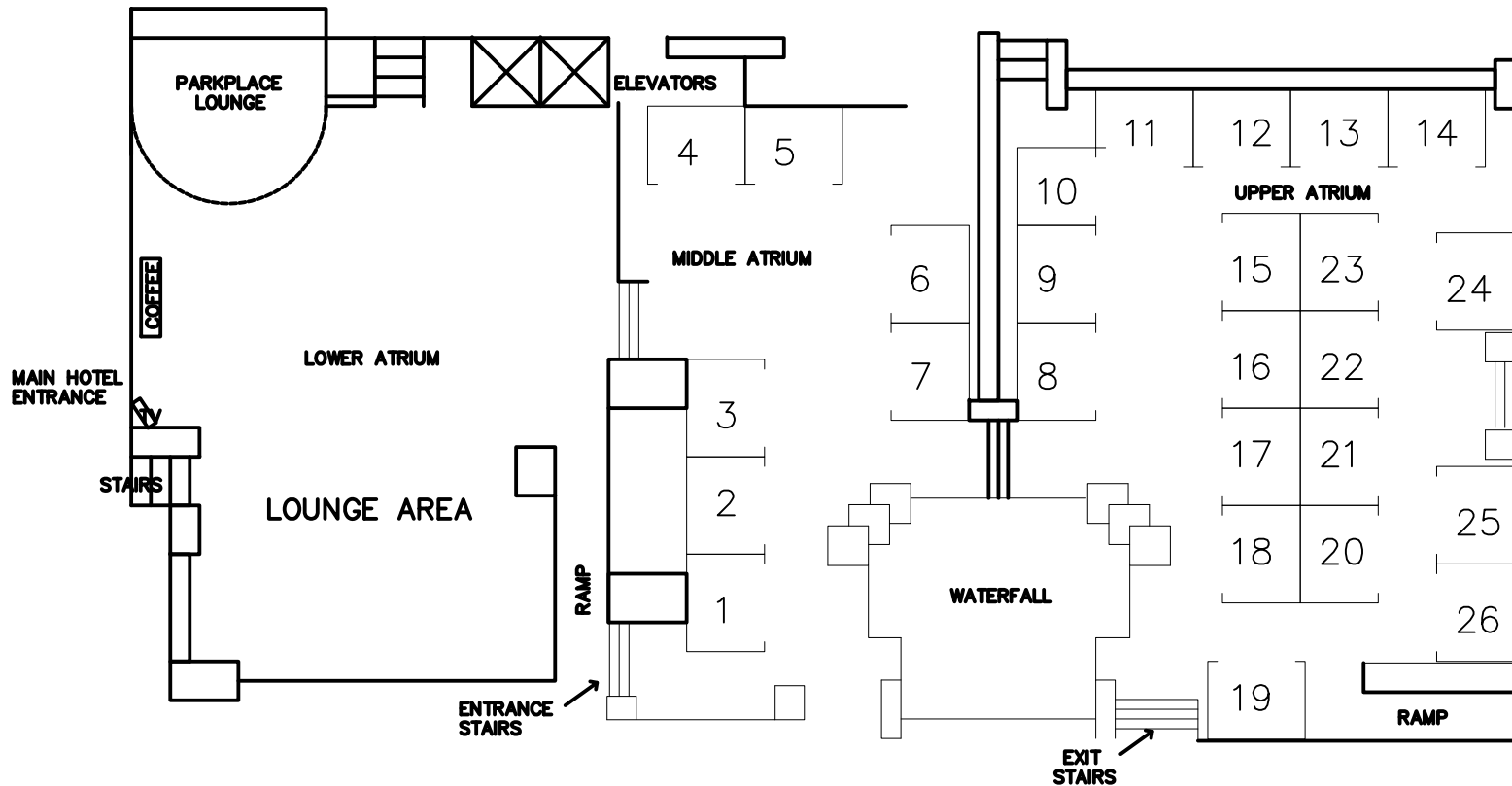

INDUSTRIAL FIREWORLD  
 MARCH 23 – 27, 2009

HOLIDAY INN  
 HOTEL & SUITES  
 UPPER & MIDDLE ATRIUMS  
 3950 I-10 SOUTH  
 BEAUMONT, TX 77705

SCALE

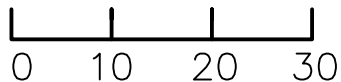

26 – 8 X 10 BOOTHS

PREPARED BY:

**George Fern Company**

Expositions • Corporate Events • Exhibits

Nationwide

7700 N. FREEWAY SUITE B, HOUSTON, TX 77037  
 (281) 260-7200 FAX (281) 260-7271

E-Mail: jtorres@georgefern.com

FILE: FIREWORLD 2009.dwg, 004/22/08 CC/JT

All information on this document is subject to Fire Marshal approval and is based on the best knowledge of the building sizes per architectural plans provided by building. Geo. E. Fern Co. is not responsible for any discrepancies in this floor plan. "This floor plan is subject to change."